

vtech[®]
baby

Quick Start Guide



Peek & Play Learning House

By reducing the quantity of paper used for our Manuals, we aim to reduce our environmental impact and contribute to the preservation of the environment. The full version of this Instruction Manual is available online through the following links or by scanning the QR code.





For UK
vtech.co.uk/manuals



For AUS
vtech.com.au/support/product_manuals

© 2026 VTech. All rights reserved. **Printed in China.**

91-004841-001  

INCLUDED IN THE PACKAGE

- Peek & Play Learning House



Electronic Panel



Shape Sorter Panel



Gears Panel



Ramps Panel



Roof



Bottom Panel

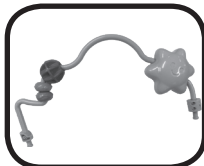

Bead Handle



3 Ramps



2 Balls

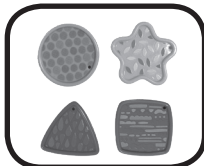

4 Shape Blocks



3 Label Sheets

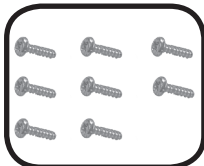

8 Screws

- Quick Start Guide

2

WARNING

All packing materials such as tape, plastic sheets, packaging locks, removable tags, cable ties, cords and packaging screws are not part of this toy, and should be discarded for your child's safety.

NOTE

Please keep this Quick Start Guide as it contains important information.

WARNING: Do not aim at eyes or face.



CAUTION:

Adult assembly required.

This package contains small parts.

For your child's safety, do not let your child play with the toy until it is fully assembled.

Unlock the Packaging Locks:

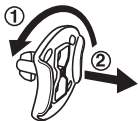

- ① Rotate the packaging lock 90 degrees anticlockwise.
- ② Pull out the packaging locks and discard.

3

GETTING STARTED

Battery Removal and Installation

1. Make sure the unit is turned **Off**.
2. Locate the battery cover on the bottom of the unit, use a screwdriver to loosen the screw and then open the battery cover.
3. If present, remove the old batteries by pulling up on one end of each battery.
4. Install 2 new 1.5V AA (LR6) batteries following the diagram inside the battery box (for best performance, alkaline batteries or fully charged Ni-MH rechargeable batteries are recommended).
5. Replace the battery cover and tighten the screw to secure.

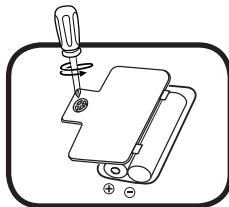

WARNING:

Adult assembly required for battery installation.
Keep batteries out of reach of children.

IMPORTANT: BATTERY INFORMATION

- Insert batteries with the correct polarity (+ and -).
- Do not mix old and new batteries.
- Do not mix alkaline, standard (carbon-zinc) or rechargeable batteries.
- Only batteries of the same or equivalent type as recommended are to be used.
- Do not short-circuit the supply terminals.
- Remove batteries during long periods of non-use.
- Remove exhausted batteries from the toy.
- Dispose of batteries safely. Do not dispose of batteries in fire.

RECHARGEABLE BATTERIES:

- Rechargeable batteries are only to be charged under adult supervision.
- Do not charge non-rechargeable batteries.

Disposal of batteries and product



The crossed-out wheeled bin symbols on products and batteries, or on their respective packaging, indicates they must not be disposed of in domestic waste as they contain substances that can be damaging to the environment and human health.

The chemical symbols Hg, Cd or Pb, where marked, indicate that the battery contains more than the specified value of mercury (Hg), cadmium (Cd) or lead (Pb) set out in the Batteries and Accumulators Regulation.



The solid bar indicates that the product was placed on the market after 13th August, 2005.

Please dispose of your product and batteries responsibly.

In the UK, give this toy a second life by disposing of it at a small electricals collection point* so all of its materials can be recycled.

Learn more at:

www.vtech.co.uk/recycle

www.vtech.com.au/sustainability

* Visit www.recyclenow.com to see a list of collection points near you.

ASSEMBLY INSTRUCTIONS

With the **VTech® Peek & Play Learning House**, safety comes first. To ensure your child's safety, adult assembly is required. For your child's safety, do not let your child play with the toy until it is fully assembled.

1. Place the **Gears Panel** on the left side of the **Electronic Panel**. Press down until you hear the **Gears Panel** click into place.

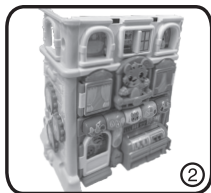
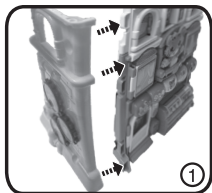

2. Turn the unit and place the **Shape Sorter Panel** on the right side of the **Gears Panel**. Press down until you hear the **Shape Sorter Panel** click into place.

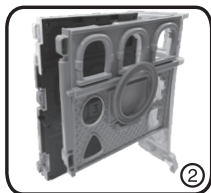
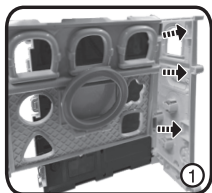

3. Place the **Ramps Panel** between the **Electronic Panel** and the **Shape Sorter Panel**. Press down until you hear the **Ramps Panel** click into place.

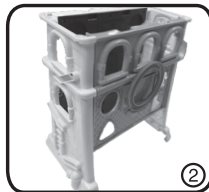
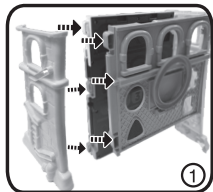

4. Turn the unit upside down. Align the **Bottom Panel** with the six slot on the underside of the unit. Press down firmly until the **Bottom Panel** clicks into place. Secure the **Bottom Panel** with four screws.

NOTE: Please make sure the engraved side of the Bottom Panel is facing inside the house, with the smooth unengraved side towards the floor.

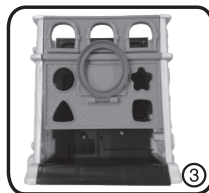
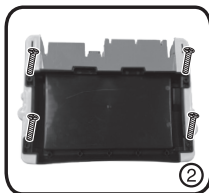
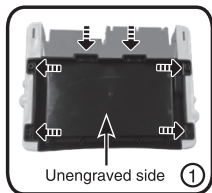

7

5. Turn the unit upright. Place the **Roof** on top of the assembled unit. Align the screw holes. Secure the **Roof** with four screws.

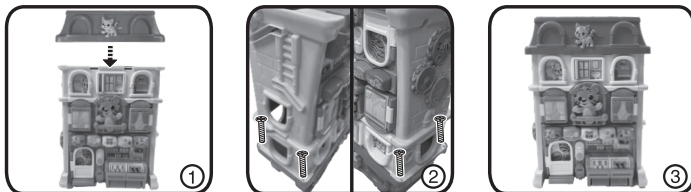

6. The bottom of each **Ramp** is labelled 1, 2, or 3. Match each ramp to the groove with the same number. Press down until the **Ramp** clicks into place.

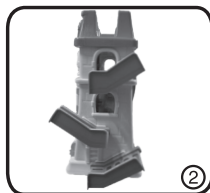
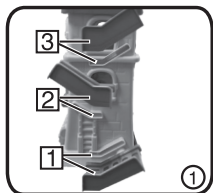

7. Insert the **Bead Handle** into the **Gears Panel**. Press down until you hear the **Bead Handle** click into place.

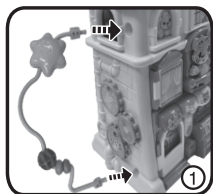

8

LABEL APPLICATION

Firmly apply the labels to the panels as shown below.

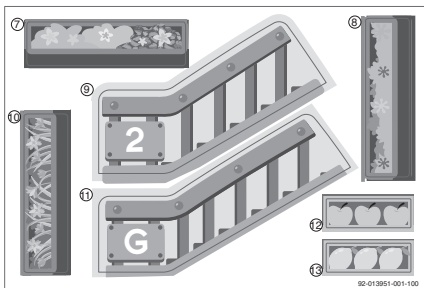
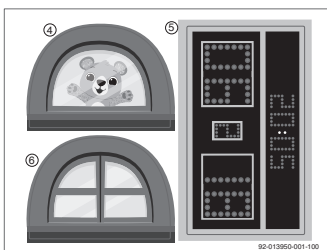
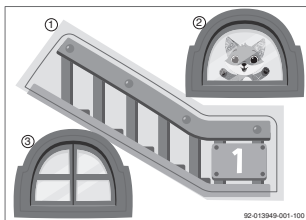

9

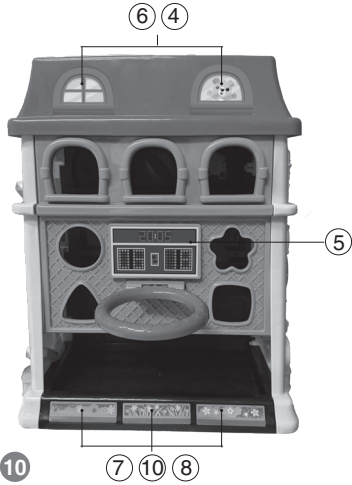
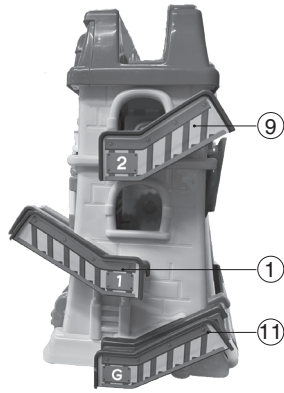



CARE & MAINTENANCE

1. Keep the unit clean by wiping it with a slightly damp cloth.
2. Keep the unit out of direct sunlight and away from any direct heat sources.
3. Remove the batteries if the unit will not be in use for an extended period of time.
4. Do not drop the unit on hard surfaces and do not expose the unit to moisture or water.

PRODUCT WARRANTY/ CONSUMER GUARANTEES

UK Customers:

Read our complete warranty policy online at vtech.co.uk/warranty.

Australian Customers:

VTECH ELECTRONICS (AUSTRALIA) PTY LIMITED – CONSUMER GUARANTEES

Under the Australian Consumer Law, a number of consumer guarantees apply to goods and services supplied by VTech Electronics (Australia) Pty Limited. Please refer to vtech.com.au/consumerguarantees for further information.

Contact VTech

Tel: 0330 678 0149 (from UK)
+44 330 678 0149 (outside UK)
1800 862 155 (Aus) / 0800 400 785 (NZ)
www.vtech.co.uk
www.vtech.com.au